

amer

— YACHTS —

amer centro
— quad —
— premier —





amer cento

www.ameryachts.com





amer cento

www.ameryachts.com





amer cento

www.ameryachts.com





















amer cento
www.ameryachts.com







amer cento
www.ameryachts.com





amer cento
www.ameryachts.com



amer cento

www.ameryachts.com









FLY DECK



MAIN DECK



LOWER DECK



FLY DECK



MAIN DECK



LOWER DECK

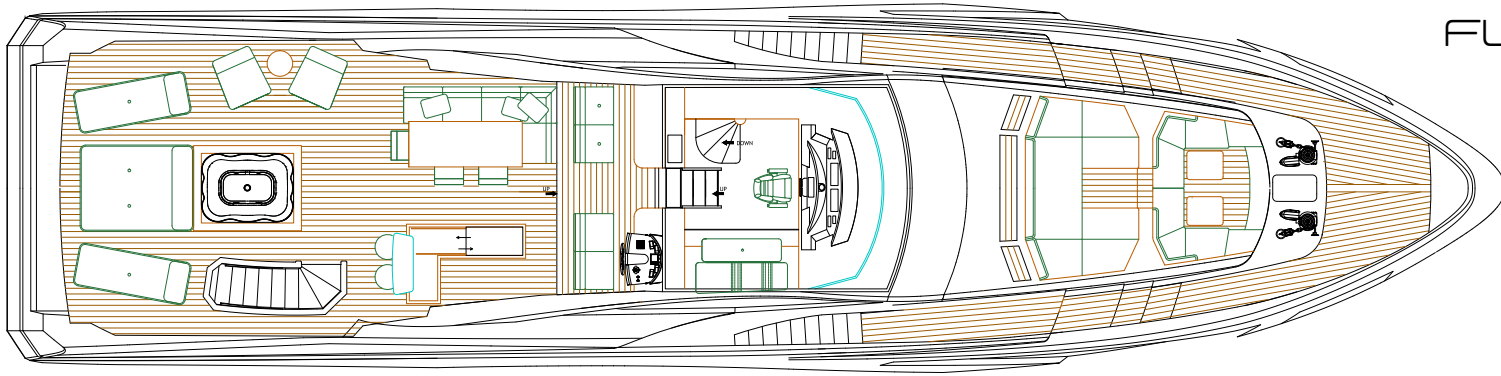

FLY DECK

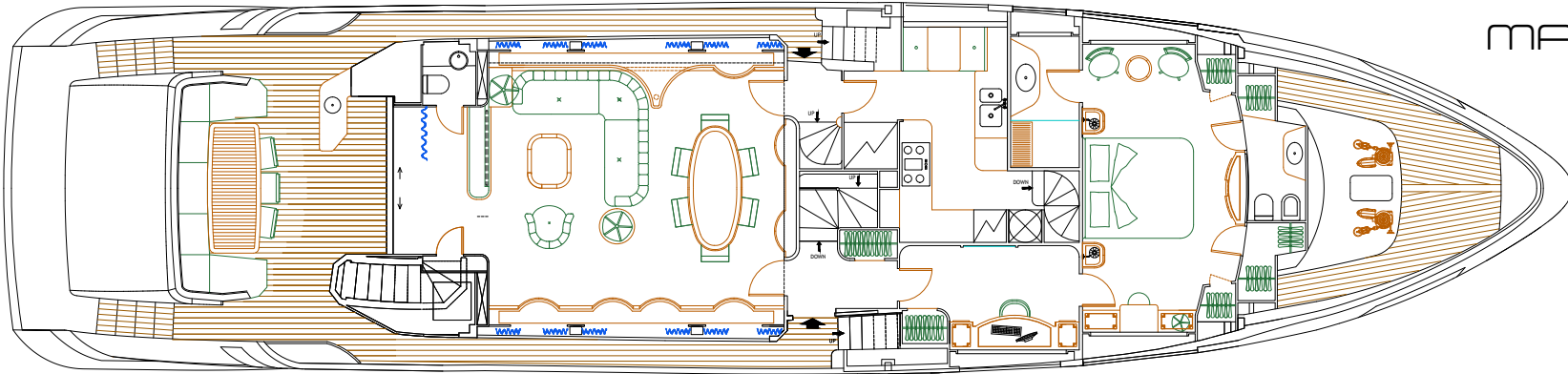

MAIN DECK

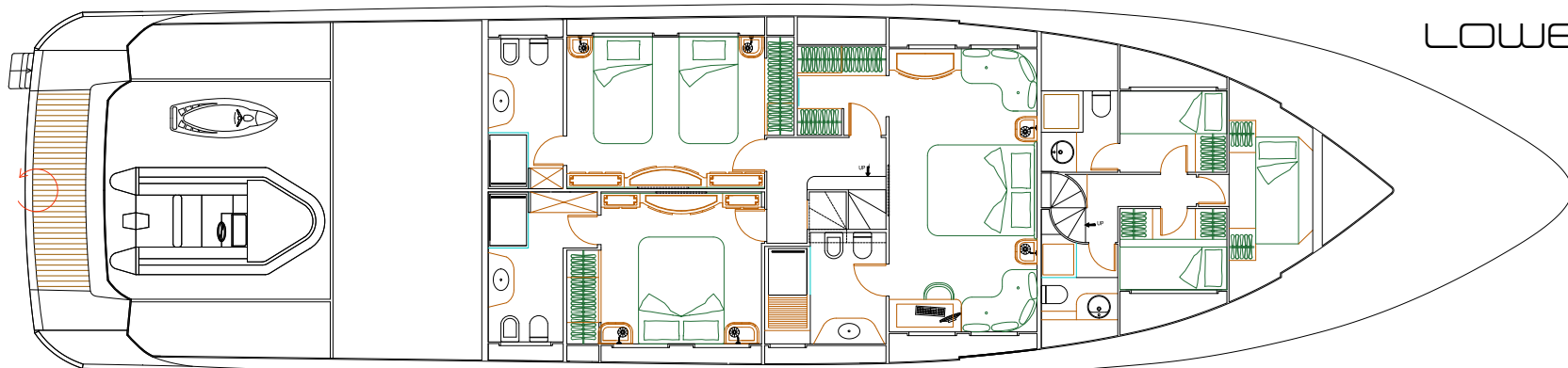

LOWER DECK

amer cento

LOA
Lunghezza scafo
Larghezza

29,60 m
23,96 m
7,00 m

LOA
Length hull
Beam

Immersione massima
a pieno carico

1,95 m - 2,05 m

Maximum draft
fully loaded

Dislocamento

85 Tons

Displacement

Materiale

VTR

Material

Motorizzazione

4 x Volvo Penta IPS 1050 3 x Volvo Penta IPS 1350

Propulsion

Combustibile
Acqua dolce

10.000 l
2.000 l

Fuel tank
Water tank

Velocità di crociera
Velocità massima

24
28

Cruising speed
Top speed

www.ameryachts.com